

# AEOL



OMNIDIRECTIONAL ELEVATED RUNWAY LOW INTENSITY APPROACH, THRESHOLD AND WING BAR, RUNWAY END, THRESHOLD/RUNWAY END, STOP WAY, TOUCHDOWN INDICATOR AND FILLETS LIGHT

## COMPLIANCES

**ICAO:** Annex 14 – Volume I and II Heliports, Fig.5-11 III.2

**FAP-170:** Runway Low Intensity lights

## APPLICATIONS

Runway low intensity lights for approach, threshold and wing bar, threshold/runway end, runway end, stopway, touchdown indicator and fillets lights.

## BENEFITS

- Single lamp offer a quick and easy replacement without need of tools.
- 1500 hours lamp rated life at full intensity (500 h for 120W lamps), but over 3000 hours in field operating conditions.
- Designed with simplicity allowing longer maintenance intervals and fewer spare parts.
- Symmetric Fresnel clear lens, made of heat resistant glass fastened to the body by means of a stainless steel clamp. A silicon O-Ring between lens and body is provided for watertight with no use of any sealing for is quick and easy replacement.
- No optical adjustment after lamp or lens replacement.
- Unidirectional use with shielded lens.

## PERFORMANCES

- Lightweight and sturdy due to aluminium die-castings
- Powder coating surface finishing to provide good corrosion resistance
- Body complete with a suitable coupling for direct mounting on breakable coupling or on the top of 60 mm dia supporting pole
- Protection degree: IP54
- Temperature range: -55°C to +55°C

## INSTALLATION

- The fixture can be installed on pipe elbow or baseplate.

## PHOTOMETRIC PERFORMANCES

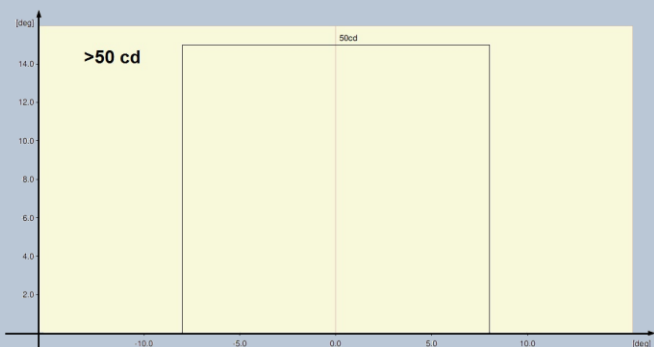

Fig. 1: FAP-170 6.1.5 Low Intensity Touchdown Indicator

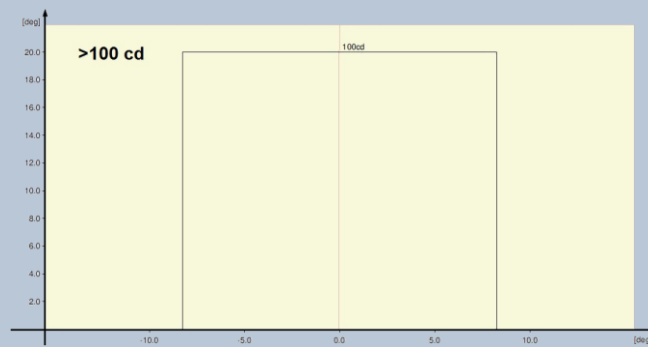

Fig. 2: FAP-170 6.1.2.3 Low Intensity Runway Approach

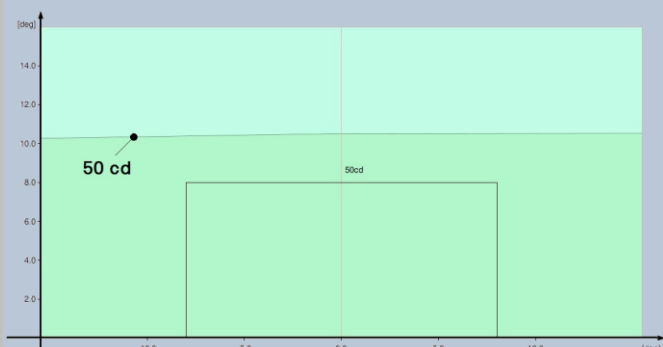

Fig. 3: FAP-170 6.1.6 Low Intensity Threshold and Wing Bar

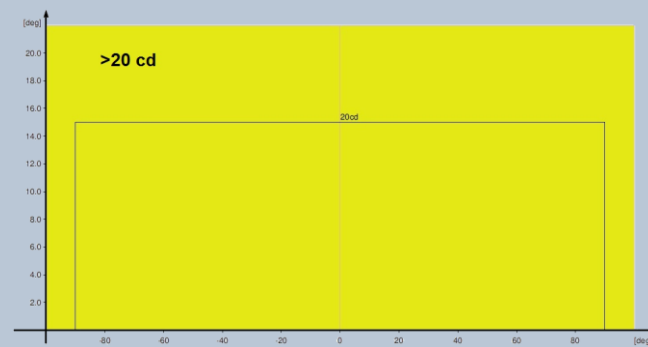

Fig. 4: FAP-170 6.1.17 Low Intensity Fillets

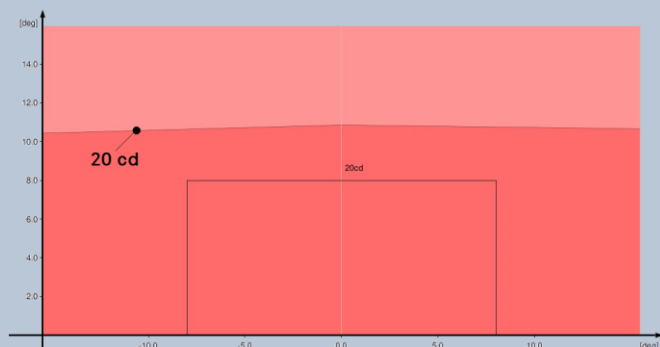

Fig. 5: FAP-170 6.1.7 Low Intensity Runway End

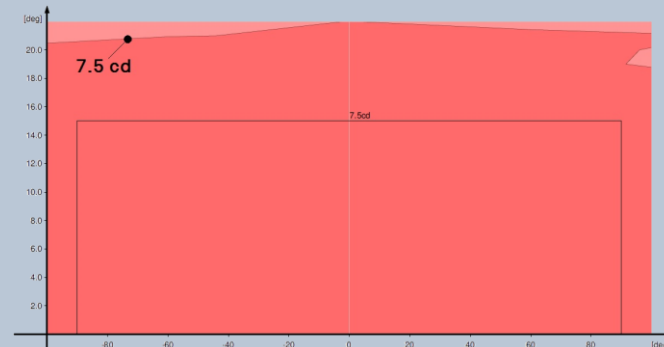

Fig. 6: FAP-170 6.1.16 Low Intensity Stopway

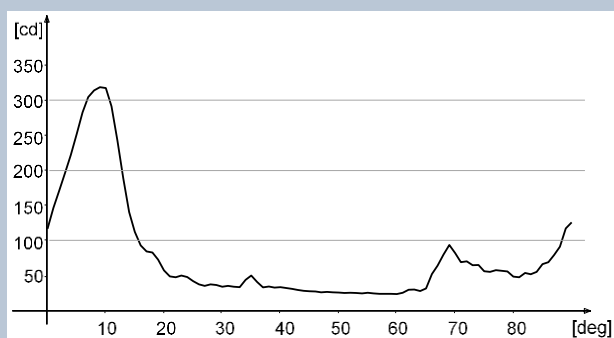
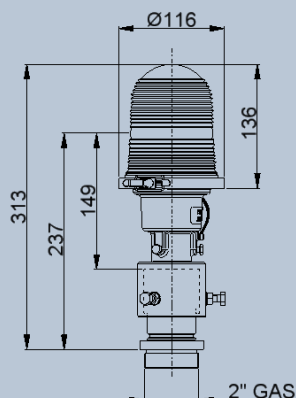
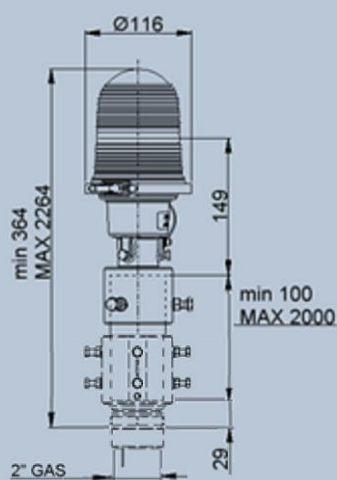

Fig. 7: ICAO Annex 14 Vol. I Low Intensity Runway Approach



Configuration P-001



Configuration C-250

**AEOL - I - A - CC -120 - P-001****Basic P/N:** \_\_\_\_\_**Compliance:** \_\_\_\_\_

I = ICAO

R = FAP-170 (Russia)

**Use Code:** \_\_\_\_\_

See Tab. A

**Colour:** \_\_\_\_\_

See Tab. A

**Lamp:** \_\_\_\_\_

045 = 1x45W 6.6A GZ 9.5

120 = 1x120W 6.6A GZ 9.5

**Configuration:** \_\_\_\_\_

P-001 = Fixture complete with breakable coupling

C-250 = Semi-assembled fixture with a cable lead of L= 2.5 m(\*)

P-090 = Fixture complete with mounting pole, 90 cm long, and breakable coupling (only use code T and colour RR)

P-175 = Fixture complete with mounting pole, 175 cm long, and breakable coupling (only use code T and colour GG)

(\*) Mounting pole and breakable coupling must be ordered separately (see accessories)

**TABLE A**

Use	Description	Colour <sup>y</sup>	Lamp	Compliance
A	Low Intensity Runway Approach	CC	45 W	I = ICAO
	Low Intensity Runway Approach		120 W	R = FAP-170 par.6.1.2.3
G	Low Intensity Threshold and Wing Bar	GX	45W	R = FAP-170 par.6.1.6
E	Low Intensity Runway End	RX	45W	R = FAP-170 par.6.1.7
R	Low Intensity Threshold/Runway End	GR	45W	R = FAP-170 par.6.1.6 and par.6.1.7
D	Low Intensity Runway Edge	CC CY YR	45W	R = FAP-170 par.6.1.4
S	Low Intensity Stopway	RX	45W	R = FAP-170 par.6.1.10
F	Low Intensity Fillets	YX	45W	R = FAP-170 par.6.1.17
U	Low Intensity Touchdown Indicator	CX	45W	R = FAP-170 par.6.1.5
T	In combination with B747 turning pad panels	RR GG	45W	ICAO

<sup>y</sup> Colour: C = Clear, R = Red, G = Green, Y = Yellow, X = Shield.

**MAIN COMPONENTS OF THE LIGHT UNIT**

- 1 Lens with metallic ring and hardware
- 2 Lamp
- 3 Lampholder
- 4 Clamp for lens
- 5 O-Ring for lens
- 6 Body
- 7 Coupling with hardware
- 8 Breakable coupling
- 9 FAA L-823 plug

Refer to the relevant technical manual for the complete list of the available spare parts

**ACCESSORIES**

- 013.0010 Set of two ryton rings for receptacle support inside pipe elbow
- 013.0008 Galvanized steel pipe elbow with upper threaded end only (2" - 11 GAS thread)
- 315.3210 Galvanized steel pipe elbow with both threaded ends (2" - 11 GAS thread)
- 315.1228 Base L-867, Class IA, Size B, 24" Deep
- 315.1062 Baseplate for L-867 base with gasket and cable clamp (2" - 11 GAS thread)
- 155.7200 Breakable coupling for configuration C-250
- 315.3710 Supporting pole (H = 150 mm)
- 315.3711 Supporting pole (H = 500 mm)
- 315.3712 Supporting pole (H = 1000 mm)
- 315.3713 Supporting pole (H = 1500 mm)
- 315.3714 Supporting pole (H = 2000 mm)

For any information about isolating transformers and connectors, please see the specific catalogue pages

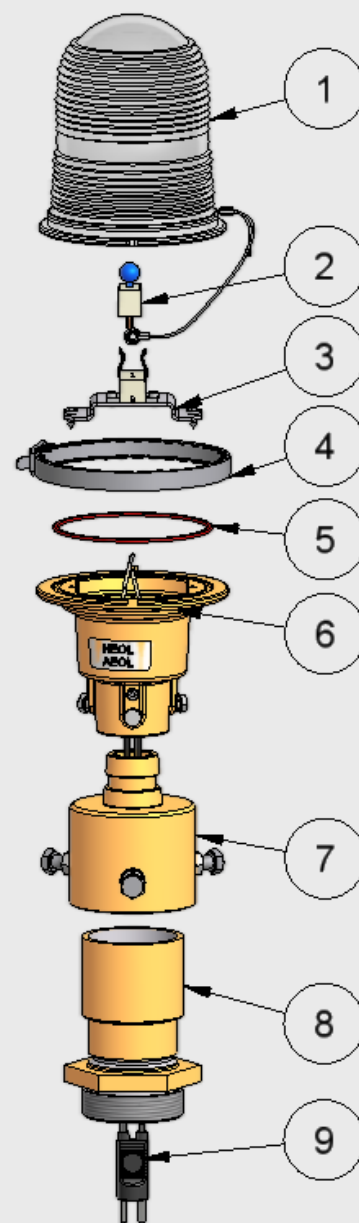

	Light Type P-001	Light Type C-250
Weight (kg)	1.5	2.2
Volume (m <sup>3</sup> )	0.009	0.009

We reserve the right to change the design or specification data without notice

UC-PU-0287\_EN-Rev.D